

# RAVAS-520

## Hand Pallet Jack

MOBILE  
WEIGHING  
SYSTEMS

If your material handling process includes piece counting or repeatable steps, the RAVAS-520 advanced scale functions will save you valuable time. With an intuitive touch screen display, multiple weighing functions, wireless connectivity, and Lithium-ion powered battery, the RAVAS-520 will enhance your warehouse operation.

### Advanced Functionality

- Standard NTEP approved
- 5" touch screen with easy to read digits
- Power supply by a rechargeable and removable Li-ion battery
- Programmable routines
- Standard with piece counting function
- Integrated data connectivity

Effortlessly lift and drive  
with handle controls

Intuitive touch  
screen display  
with 0.98 inch  
high digits. Only  
the active keys  
are visible



Level compensation  
to 3 degrees

# RAVAS-520

## FUNCTIONS

- Automatic and manual zero correction
- Gross/net weighing
- Tare memory for 10 values
- Internal clock for date and time
- On board:
  - RS232 port connection for printer
  - USB output for data transfer (with USB stick)
  - Free COM 1 for Wifi or RS232
- The USB output can also be used to connect a bar-code scanner (end of 2019)
- Connectivity for RAVAS WeightsApp

## STANDARD SPECIFICATIONS

### WEIGHT CAPACITY

- 5,000 lb.

### GRADUATION

- 0 - 3,000 lb.: graduation 1 lb., or 5,000lb.: graduation 2 lb.

### MAXIMUM TOLERANCE

- 0.1 % of applied load

### DISPLAY

- Full-color 5" touch display with 1" high digits

### POWER CONSUMPTION

- 14.8V - 160 mA

### POWER SUPPLY

- Li-ion battery pack 14.8V/5Ah incl. charger

### AUTONOMY

- 25 hours continuous use (50 hours with sleep modes)

### KEYBOARD

- Display mode defines the available keys, on/off key

### PROTECTION CLASS

- Loadcells NEMA 5, indicator NEMA 4

### INDICATOR MOUNTING

- Rotating and tiltable

### STEERING WHEELS

- Rubber

### LOADING WHEELS

- Polyurethane, single

### COLOR

- Red (RAL3000) epoxy painted

### PUMP

- Quick lift

### OWN WEIGHT

- 255 lb.

## DIMENSIONS

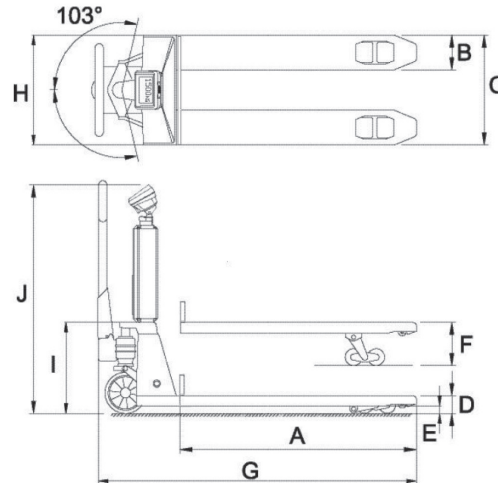

<b>A</b>	Fork Length	48"
<b>B</b>	Fork Width	7.1"
<b>C</b>	Width Over Forks	27.2"
<b>D</b>	Minimum Fork Height	3.0"
<b>E</b>	Minimum Clearance	0.7"
<b>F</b>	Maximum Fork Height	7.9"
	Lifting Height	4.8"
<b>G</b>	Overall Length	64.8"
<b>H</b>	Width Over Forks	27.2"
<b>I</b>	Minimal Chassis Height	17"

Tolerance +/- 0.1"

## OPTIONS\*

- NTEP version (2nd half of 2020)
- Thermal or matrix printer 12V
- Wireless or WiFi data transfer
- Reference scale via RS232 (for more accurate piece counting)
- Parking brake
- 1D USB bar-code scanner, not in combination with legal for trade
- Additional Li-ion battery pack
- Stainless steel chassis
- RDC, RAVAS Data Collector Software
- RIS, RAVAS Integration Software

\*The use of options may change related specifications.

